



RABINDRA MAHAVIDYALAYA

Affiliated to the University of Burdwan
Champadanga, Hooghly, West Bengal, Pin.-712401

Estd.- 1971



Ref. No...RM/199/2023

Date...23-11-2023

TENDER NOTICE

(Displayed at College Notice Board)

INVITATION OF SEALED QUOTATIONS FORMAKING ORSUPPLY OF FURNITURE ITEMS

1. Sealed quotations for Cost of Purchase not exceeding **Rs. 50,000/- (Fifty thousand only)** with judiciously comparable rates in the physical and ecommerce (amazon.com, flipkart.com, ebay.com, snapdeal.com etc, others if any) marketplaces for the stated **Category: Making or Supply of Furniture Items** are invited from the leading Manufacturers/ Authorized dealers/reputed suppliers of the above item/s, and also having post-purchase maintenance and service facilities in the Hooghly District or Kolkata region, West Bengal for the supply of the same items (for detailed list see **Annexure A** below) to the different departments of Rabindra Mahavidyalaya, Champadanga, Hooghly, W.B., PIN: 712401.
2. **One Set of complete and sealed quotation in a separate cover**, mentioning "**Sealed quotation for making or supply of furniture items**" in the title of the envelope, is to be sent and reached accordingly to the college office. The said quotation/s should be sent either through **Speed Post** addressed to the Principal, Rabindra Mahavidyalaya, Champadanga, Hooghly or by messenger/s personally and reached at the said office or the same should be deposited at the **Tender Box** in the Ground Floor beside **Room No. 6** of the institution up to **11:30 a.m. of 13/12/2023 (Wednesday)**, and the same will be opened at **12:30 p.m. on 13/12/2023 (Wednesday)** at the Principal's Chamber in the College. Interested bidders are invited to be present at the Tender Opening meeting at the scheduled time either by sending their authorized representatives or by themselves.
3. The sealed quotation should be accompanied with –(i) **at least one qualifying document** of the legal registration of the firms, shop or dealership and the **Trade License** documents provided by the appropriate government authority; GST registrations; the other registration certificates from the statutory agencies; (ii) a copy of this Tender Notice; (iii) a list of the qualified quotation/s mentioning the features for the products/ services those are strictly met out of the Tender Notice; and (iv) the Account details for electronic payment or banking transfers (optional).
4. **Any unauthorized person, vender, seller or dealer is barred to submit tender quotation/s for the above items and thereby, is prohibited to participate in the competitive bidding process.** Incomplete Quotations or quotations with insufficient information if received will be summarily rejected. On any aspect regarding the purchase process, the decision of the Purchase Sub-Committee of Rabindra Mahavidyalaya, Champadanga, Hooghly is final.
5. The respective Quotation Price should explicitly include the charges for configuration, installation, delivery, and all other incidental charges mentioned within the quotation itself. If the bidder/s does not mention any such costs, it will be assumed that it would incur no such costs. **There is no Tender Fee.**
6. An Earnest Money, if imposed, is refundable only on completion of the Work Order, and the same will be fixed on the tender opening date on a case-to-case basis by the Purchase Sub-Committee of the College.
7. A brief specification of the **Furniture items** to be purchased through this tender notice is given in **Annexure A** and interested bidders may visit the college website www.rabindramahavidyalaya.ac.in for the other details.

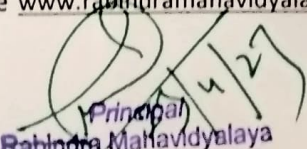
Principal
Rabindra Mahavidyalaya
Champadanga, Hooghly



RABINDRA MAHAVIDYALAYA

Affiliated to the University of Burdwan
Champadanga, Hooghly, West Bengal, Pin.-712401

Estd.- 1971



Ref. No.....

Date.....

Annexure A

Department	Sl. No.	Item	Make/Model	Detailed Specifications	Quantity
Botany	1	Segun Wooden Wall Magazine Boardwith front glass door	Segun Wood	Measurement is attached with the image	01
	2	Segun Wooden Notice Boardwith front glass door	Segun Wood	Measurement is attached with the image	02
	3	Renovation of Bioinformatics Lab	Segun Wood	<ul style="list-style-type: none"> 5 ft (Height)x 7+10 =17 ft(length) Measurement is attached with the image 	01
Mathematics	4	Wall book almirah with front glass door	Segun Wood	<ul style="list-style-type: none"> Hight 4ft,width 3ft 6inch, depth 12 inch 3-piece glass door with cobza system 2-piece rack for book inside the almirah Gala palish all body and rack Fittings in wall. Segun wood all are 3/4" thickness 4mm glass Segun wood door frame with door handle and lock 3/4-inch thickness segunwood rack Measurement is attached with the image 	01
Statistics	5	Table with drawer system	Shal/Segun wood	<ul style="list-style-type: none"> Table 'L' type, threeDrawer Body wooden, top ply wood with sanmaica Gala palish brown colour Measurement is attached with the image 	01
	6	Woodenchair	Shal/Segun wood	<ul style="list-style-type: none"> Body wooden,without handel Sample image is attached 	01

8. Mandatory Conditions:

- The product/s will be checked and verified by the respective office and/or departments of the College after completion of the work. On satisfaction, the process of payment will be initiated in favour of the bidder who has received the work order.
- The completion of work has to be done within thirty (30) days from the issue of the work order if not a relaxation in time period is offered in the Work Order. If the bidder fails to accomplish the work order, the Work Order will be treated as cancelled.
- If anything found in violation of the Tender Notice and the Work Order, the work order will be cancelled and the college authority will bear no responsibility for either of the vendor's preliminary delivery and/or installation cost or any other costs/charges thereof.

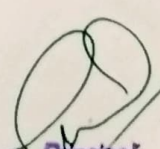
Principal
Rabindra Mahavidyalaya
Champadanga, Hooghly

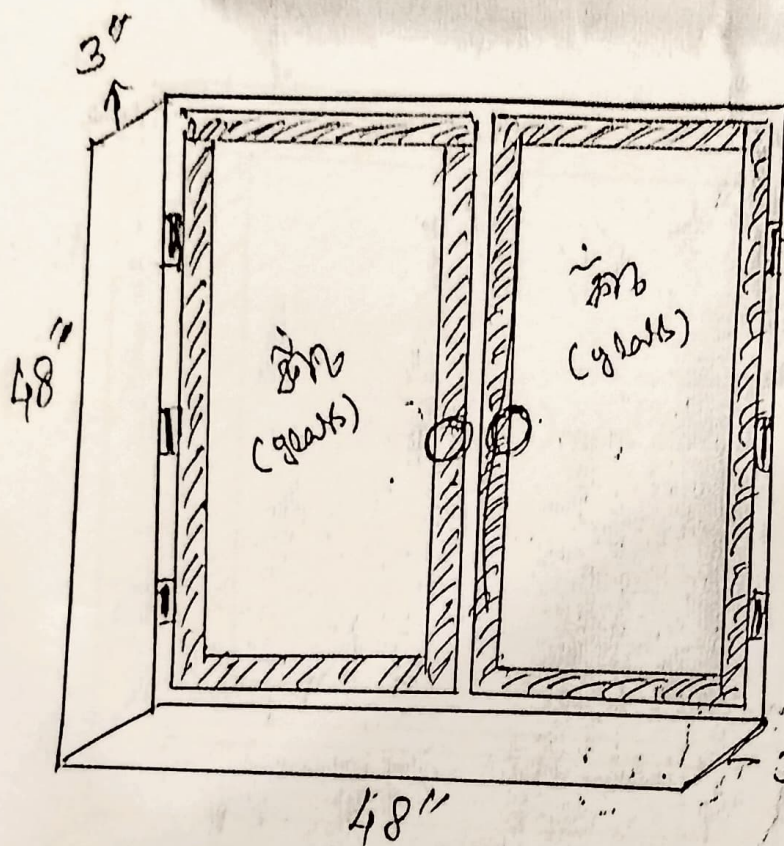

Annexure 2

3" x 1" (Teak wood frame)

6mm (Back side make with plywood)

4mm (Front-glass)

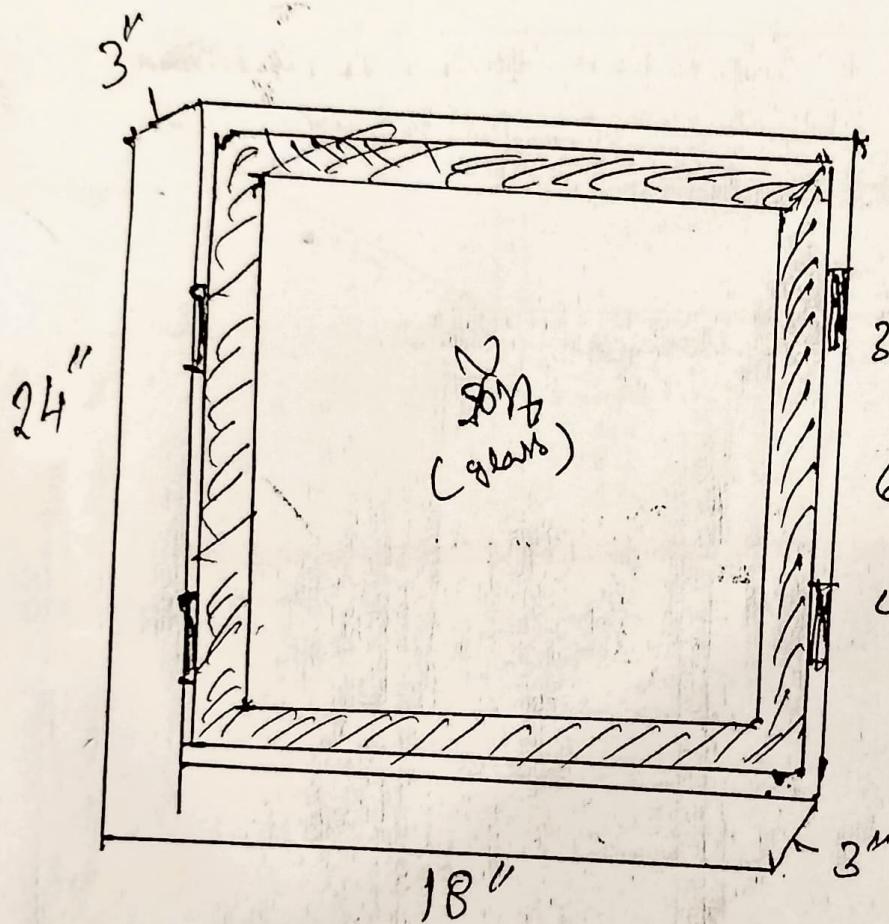

Annexure 3

2" x 1" (Teak wood frame)

6mm (Back side make with plywood)

4mm (Front glass)

ANNEXURE 1

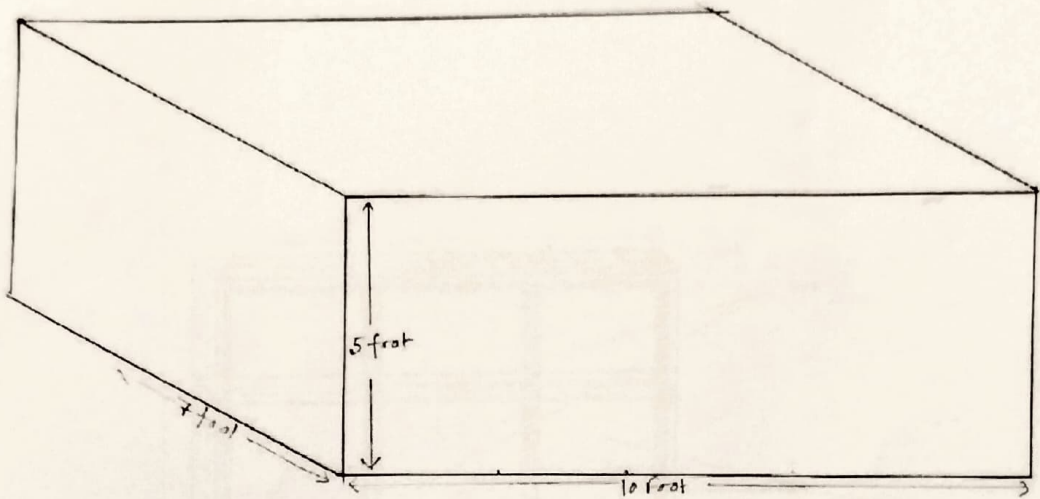

Detailed specifications for Renovation of Bioinformatics Lab (with an outline diagram)

